

## TECHNICAL FEATURES and FUNCTIONS

### 1. DIMENSIONS

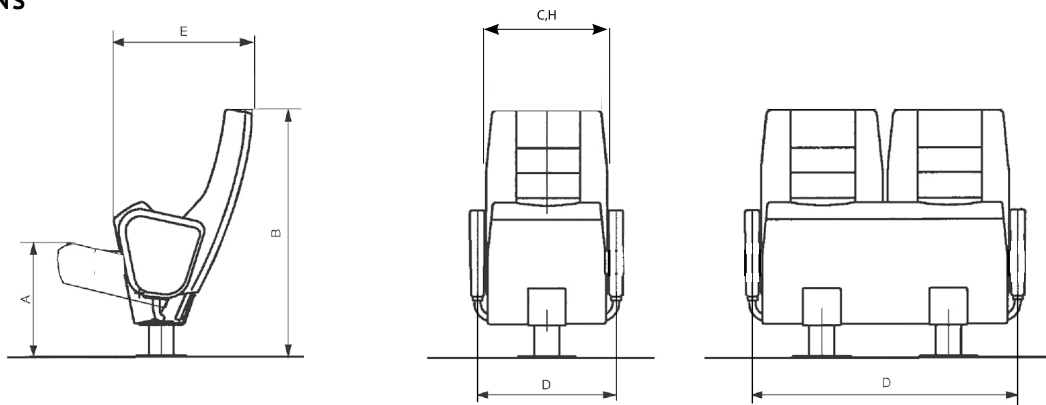

Oscar Flex

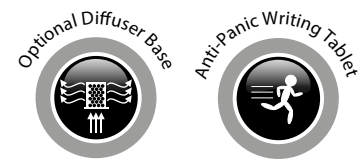

Dimensions (cm)	Overall width D	Total depth E	Total height B	Seat height A	Seat width C	Seat depth F#	Backrest height G	Backrest width H	Weight (kg)
<b>Oscar Standard</b>	57	75	100	45	47	45	71	50	26,5
<b>Oscar Flex</b>	55-60	54 - 77	102	44	48	45	71	48	29,5
<b>Oscar Love Seat</b>	114	75	100	44	104	45	71	104	45

# According to DIN norms, up to the lumbar support point

### 2. MATERIALS

#### 2.1. Construction

The seat and backrest carrier metals are welded to the central leg. The seat is mounted on the floor from 4 points on the single metal base in the center.

#### 2.2. Backrest

It is produced from injection polyurethane in a form suitable for back ergonomics. The back board made of beech wood is combined with cold foam and completely fabric is laid.

#### 2.3. Seat

It is produced from injection polyurethane in a form suitable for ergonomics. The seat board made of beech wood is combined with cold foam and completely fabric is upholstered.

#### 2.4. Metal Parts

Metal parts are electrostatic powder paint black (RAL 9005).

#### 2.5. Foaming Parts

It is injection polyurethane and does not contain CFC (chlorofluorocarbons).  
Density: 59 kg/m<sup>3</sup> +/- 3  
Seat foam thickness: 52 mm  
Backrest foam thickness: 51mm

### 3. OPTIONS

#### 3.1. Armrest Types

**Oscar Standard:** Armrest with foam and fabric upholstery on wooden frame.

**Oscar Flex (RAM armrest):** Foam and fabric fully upholstered on metal carcass.

**Oscar Flex (PU armrest):** Hollow or upholstered with a 25 mm thick polyurethane frame.

**Oscar Flex (Armrest with Writing Tablet):** Foam and fabric fully upholstered on MDF coated metal carcass.

Armrest lower covers: It is made of sheet metal to hide the armrest carrier pipe, which can be used optionally in PU and headrest armrests with writing tablets.

#### 3.2. Cup Holder

Made of reinforced polyamide. It is approximately ø140 mm in diameter and is mounted on the front of the armrest with screws.

#### 3.3. Fabric

In addition to the available fabric options, there are non-flammable fabric types for safety.

#### 3.4. Other Options

- Optional armrests for different castorbases
- Optional wood veneer on armrest
- Optional plastic (ABS) or contra wood back kick and outer front contra wood seat pad

- Normal or Antipanic foldable wooden writing tablet (Beech plywood, MDF - Lacquered veneer, MDF - Natural veneer)
- Optional diffuser base
- Optional cup holder, seat row numbers and aisle lighting fixture
- Optional headrest
- Foldable seat (Oscar Flex model)
- Ergonomically designed freon-free seat and backrest foam
- Adjustable backrest angle during assembly
- Four-point floor mounting
- Different axis distances applicable according to the projects.
- Possibility of installation in radial, angled and flat halls.

#### 3.5. Embroidery (Optional)

The maximum dimensions for the logo can be made at 7 cm width, and the width-length is measured in direct proportion. 100% polyester thread is used for embroidery. It can be applied to the desired area on the front or back, depending on the backrest model. A separate embroidery work is done for each logo. The yarn color closest to the logo color is selected. There is no restriction on the number of colors.

### 4. TECHNICAL RULES, TESTS AND QUALITY APPROVALS

- Tested according to "GS certificate of safety, LGA Nürnberg".
- ISO 9001 certified.
- It is TS EN 12727 certified.